

# Yardley® Standardized Molded-In Inserts

## Threaded Inserts Designed for Molding in Plastics, Rubber and Ceramics



### Type A

#### Advantages

- Class II threads meet A.S.M.E. (U.S.) specifications
- Metric threads meet ISO specifications
- Holes tapped to maximum depth for overall length
- Holes burnished after tapping
- For use with or without locating pins

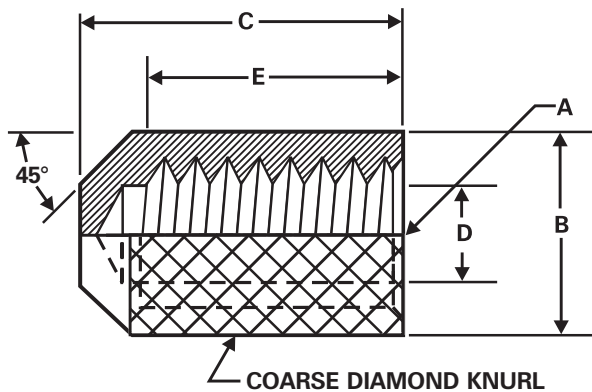

**Available from stock in Brass, Aluminum and Stainless Steel**

Custom sizes/materials available

U.S. Part Number	Metric Part Number	A U.S. Thread Size	A Metric Thread Size	B Diameter Over Knurl	C Length +.000 -.010	D U.S. I.D. Tolerance +.0015 -.0000 after tapping	D Metric I.D. (Inches) +.0015 -.0000 after tapping	E U.S. Minimum Number of Full Threads	E Metric Minimum Number of Full Threads
256A4-6 <sup>1</sup>	2004A4-6 <sup>1</sup>	2-56	M2.0 X 0.4	.133	.187	.070	.064	5	5-1/2
440A5-8	3005A5-8	4-40	M3.0 X 0.5	.169	.250	.089	.100	5	7-1/2
540A6-9 <sup>2</sup>		5-40		.200	.281	.104		6	
632A6-10	3506A6-10	6-32	M3.5 X 0.6	.200	.312	.110	.117	5-1/2	7
832A7-11	4007A7-11	8-32	M4.0 X 0.7	.232	.344	.136	.133	6	6-1/2
1024A8-12		10-24		.266	.375	.154		4-1/2	
1032A8-12	5008A8-12	10-32	M5.0 X 0.8	.266	.375	.161	.168	6-3/4	6-1/2
25020A12-18	6010A12-18	1/4-20	M6.0 X 1.0	.391	.562	.204*	.200*	6-1/2	8-1/2
25028A12-18 <sup>3</sup>		1/4-28		.391	.562	.215*		10	
31218A16-21 <sup>3</sup>	80125A16-21 <sup>3</sup>	5/16-18	M8.0 X 1.25	.516	.656	.261**	.267**	6-3/4	7-1/2
37516A18-24 <sup>3</sup>	10015A18-24 <sup>3</sup>	3/8-16	M10.0 X 1.50	.578	.750	.318**	.337**	7	7
50013A24-30 <sup>3</sup>	120175A24-30 <sup>3</sup>	1/2-13	M12.0 X 1.75	.766	.937	.430**	.404**	6-1/2	7

Materials: (1) Brass and Stainless Steel only (2) Aluminum and Brass Only (3) Brass Only

Tolerances: \* +.002 -.000 after tapping \*\*Check with our engineering department for tolerances